

### BUILD THE CAR CHASSIS

**You will need:**

- 1 x Chassis Net
- 1 x Hard Acrylic Tube
- 1 x End Cap
- 1 x Tether Line Guide (soft tube)
- 2 x Axles
- 1 x Axle Guide (small soft tube)
- 4 x Wheels
- 4 x Axle Bushes
- Scissors, Ruler

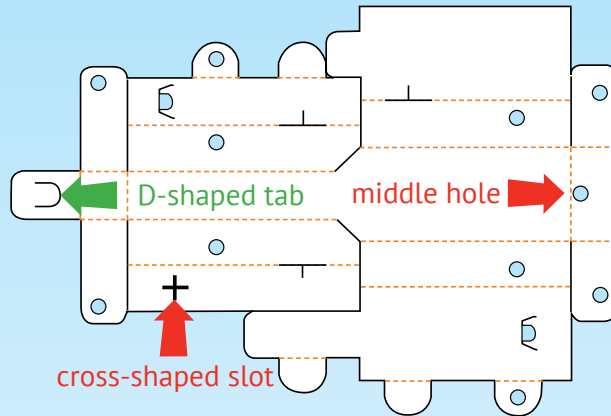

**Step 1** Remove the chassis net from the surround and push out all the pre-cut holes.

**Step 2** Take the hard acrylic tube and end cap from your consumables pack. Push the end cap onto the tube and secure using sticky tape.

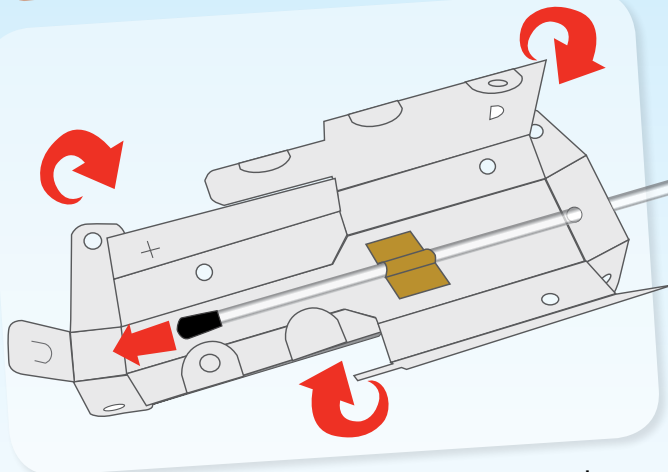

**Step 3** Fold all the score lines and insert the hard acrylic tube with the end cap through the **middle hole**. Secure with sticky tape.

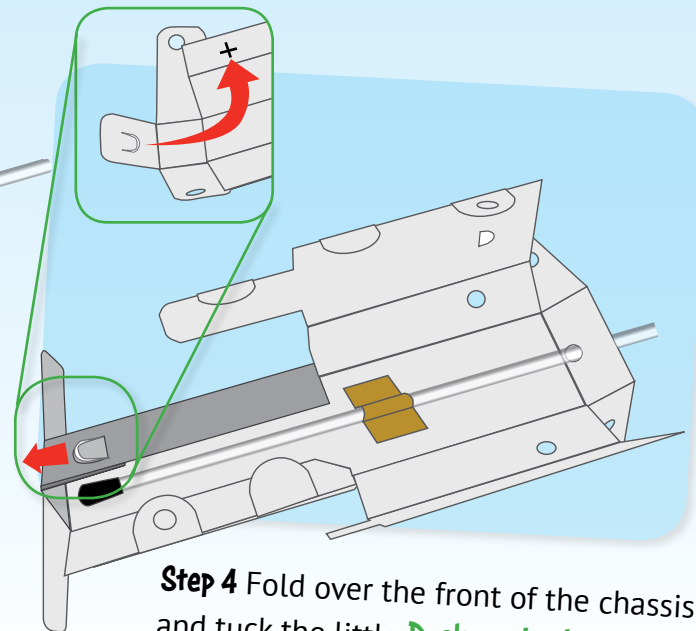

**Step 4** Fold over the front of the chassis and tuck the little **D-shaped tab** through the **cross-shaped slot** in the chassis.

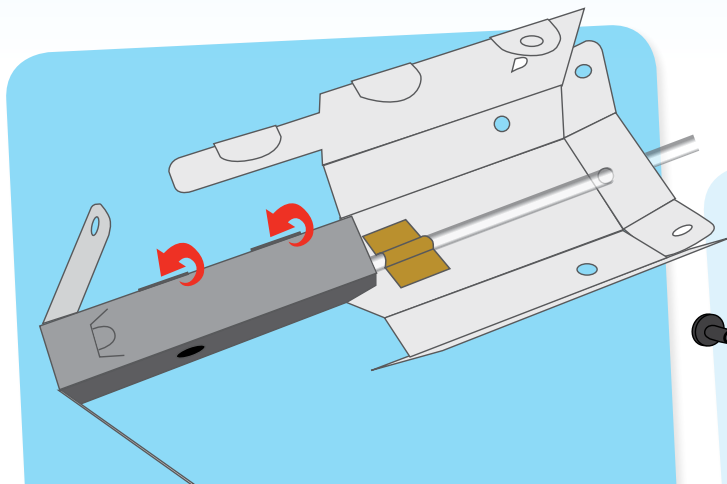

**Step 5** All solid tabs fit into pre-cut slots. All tabs with holes in should be on the outside of the car.

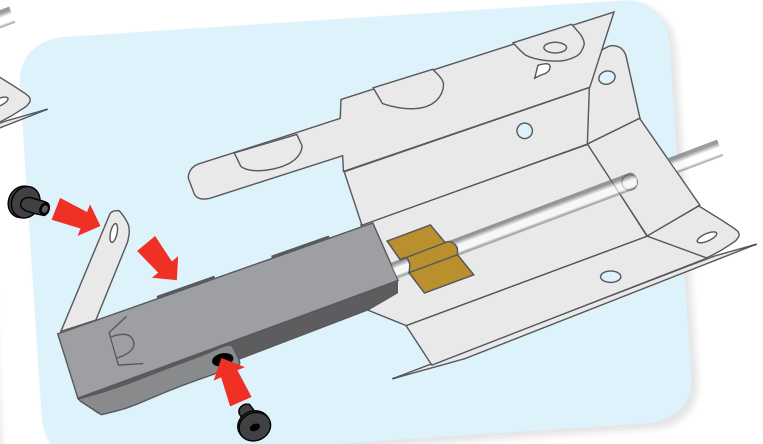

**Step 6** Line up the holes on the tabs and hold them together by pushing the **axle bushes** into place.

**Step 7** Fold the back of the car, pushing the tabs into the holes.

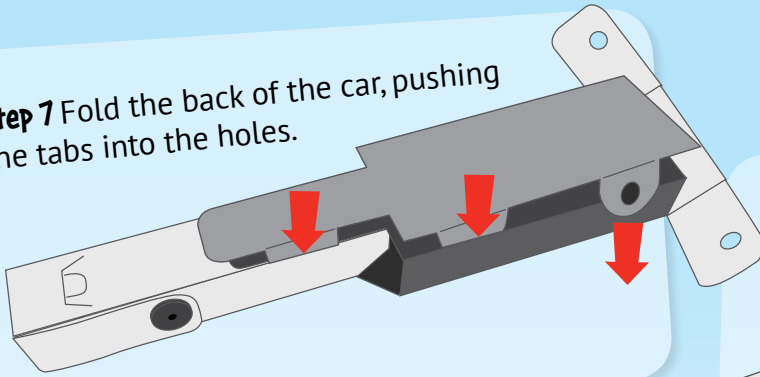

**Step 9** Push a **metal axle** through the centre of each pair of axle bushes.

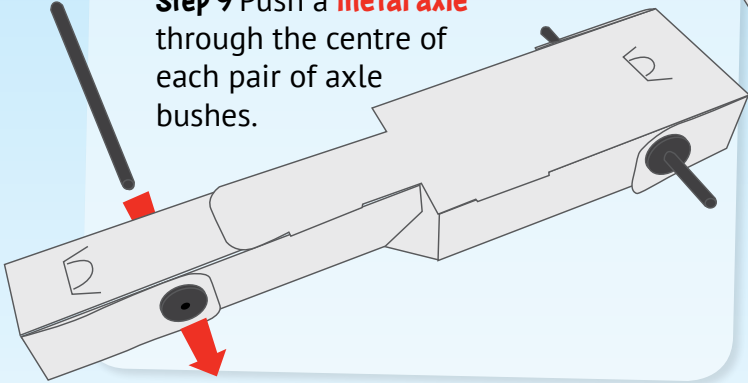

**Step 8** Fold round the rear axle flaps and hold them in place with the **axle bushes**, just like at the front of the car.

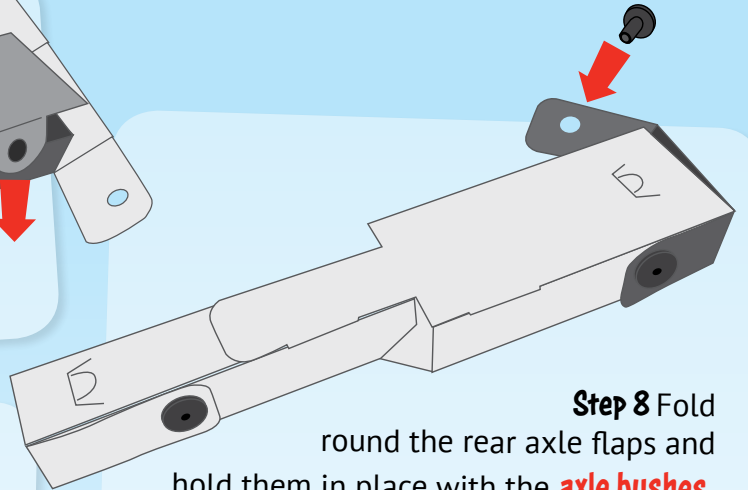

**Step 10** Using a ruler carefully measure and then cut 2 x 10mm pieces of the small plastic tube. These will be used as **axle guides**.

Add one of these axle guides to each side of the front axle only, then push the wheels onto the axles firmly.

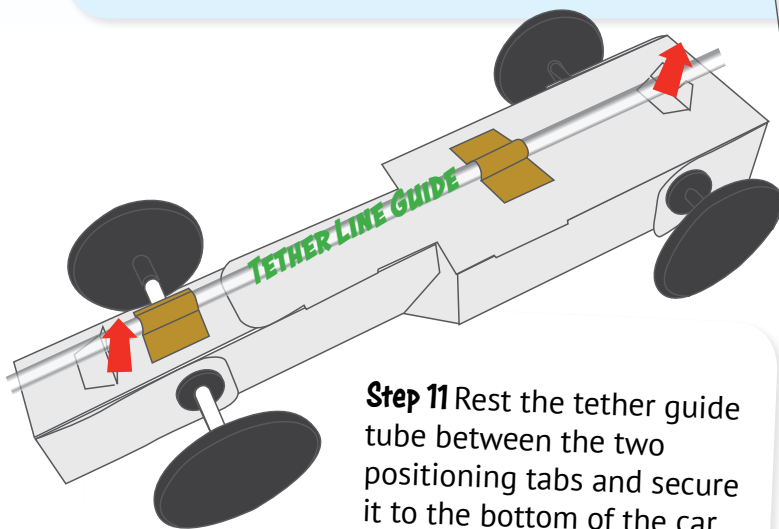
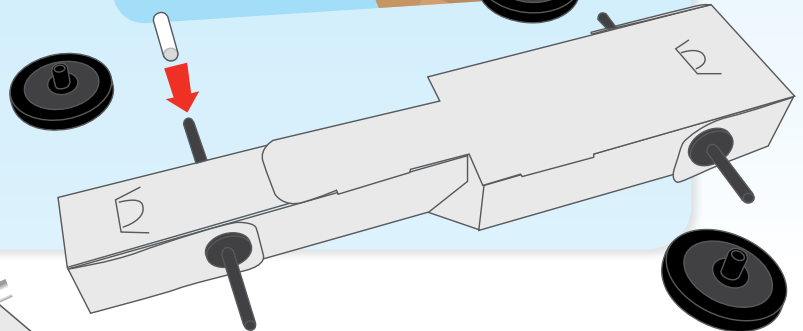
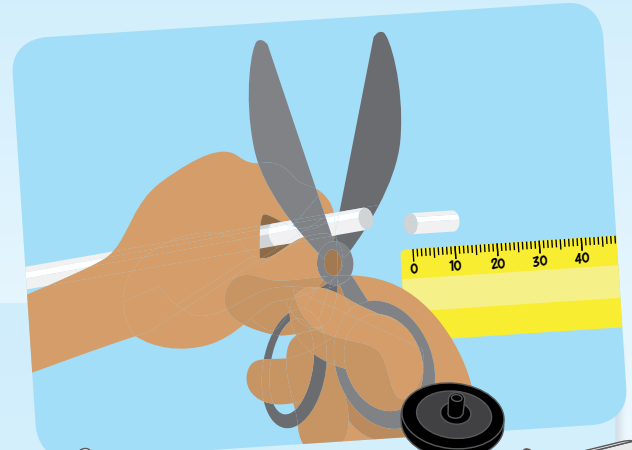

**Step 11** Rest the tether guide tube between the two positioning tabs and secure it to the bottom of the car with sticky tape.



**Step 12** Turn your car over and now you're ready to add a bodyshell.